

# 88 5559 32

## Round Dining Table

### IMPORTANT NOTE

This product is made of sturdy, high quality aluminum and will provide years of enjoyment. Do not use power tools to assemble and only tighten bolts until they are snug. Over tightening can cause damage to the aluminum.

Carefully remove all the parts from the carton and put them individually on a soft cloth to prevent scratches or other damages occurring to the parts.

We have taken great care in the design of this product and request that you carefully and strictly follow our assembly instructions to ensure a completed product as it was designed.

Home  
Styles



## Part List

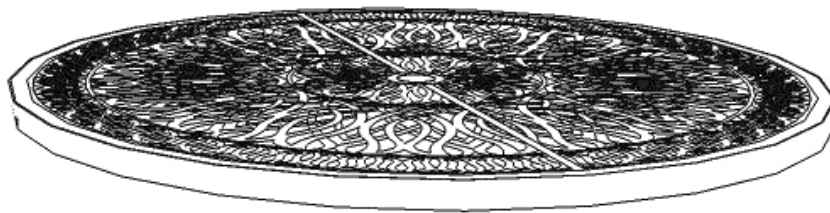

A.  
Top  
1 pc.

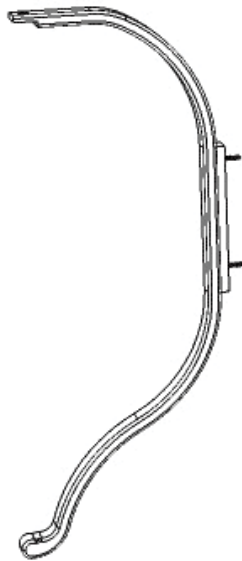

B.  
Leg  
4 pcs.

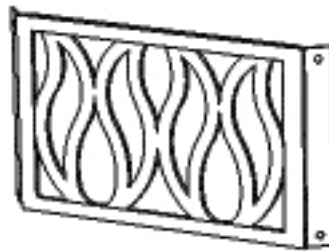

C.  
Side Frame  
4 pcs.

## Hardware List



Key Wrench  
1 pc.



Spring Washer  
12 pcs.(+1 extra)

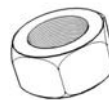

Nut  
12 pcs.(+1 extra)



Cover  
1 pc.



Bolt  
4 pcs.(+1 extra)



Flat Washer  
12 pcs.(+1 extra)

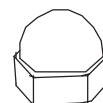

Nut Cap  
12 pcs.(+1 extra)

Tools required for assembly : **Slotted** screwdriver

Tools recommended for assembly : Level

**Home Styles Consumer Assistance:** [www.homestyles-furniture.com](http://www.homestyles-furniture.com),  
[servicedesk@homestyles-furniture.com](mailto:servicedesk@homestyles-furniture.com), 888-680-7460, 877-831-0319

# Assembly Instructions

## IMPORTANT

- \* Do not use power tools to assemble and do not overtighten the bolts.
- \* Do not tighten up all the bolts until each part is properly assembled.
- \* You should keep Key Wrench in a safe place as you may need to tighten up the Nuts in the future.
- \* After assembly, item must be level to work properly. Use the included adjustable levelers to level.

## STEP 1

Assemble Side Frames (C) and Legs (B) with Flat Washers, Spring Washers, Nuts and Nut Caps. (See figure 1)

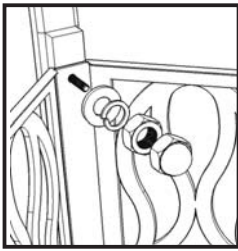

Figure 1

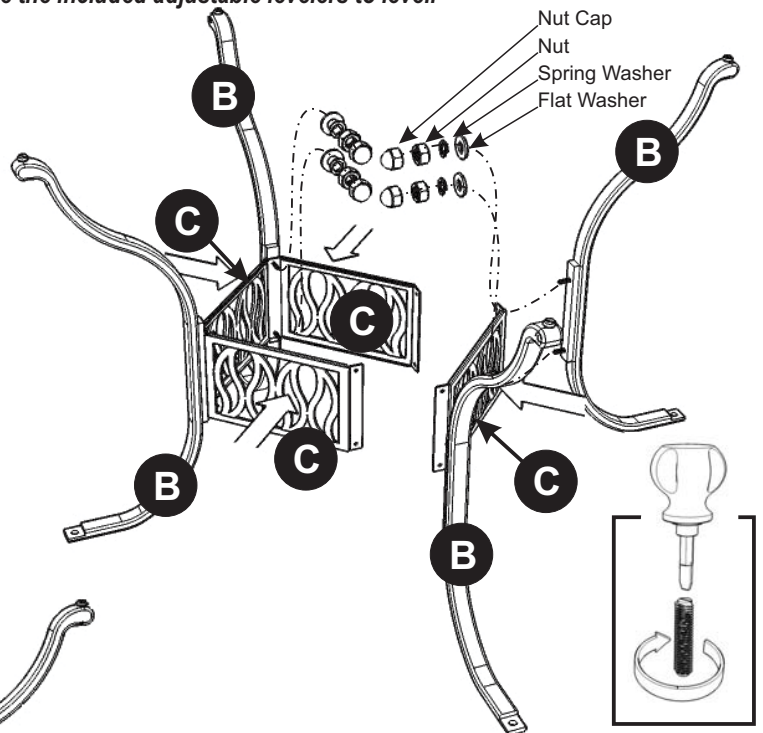
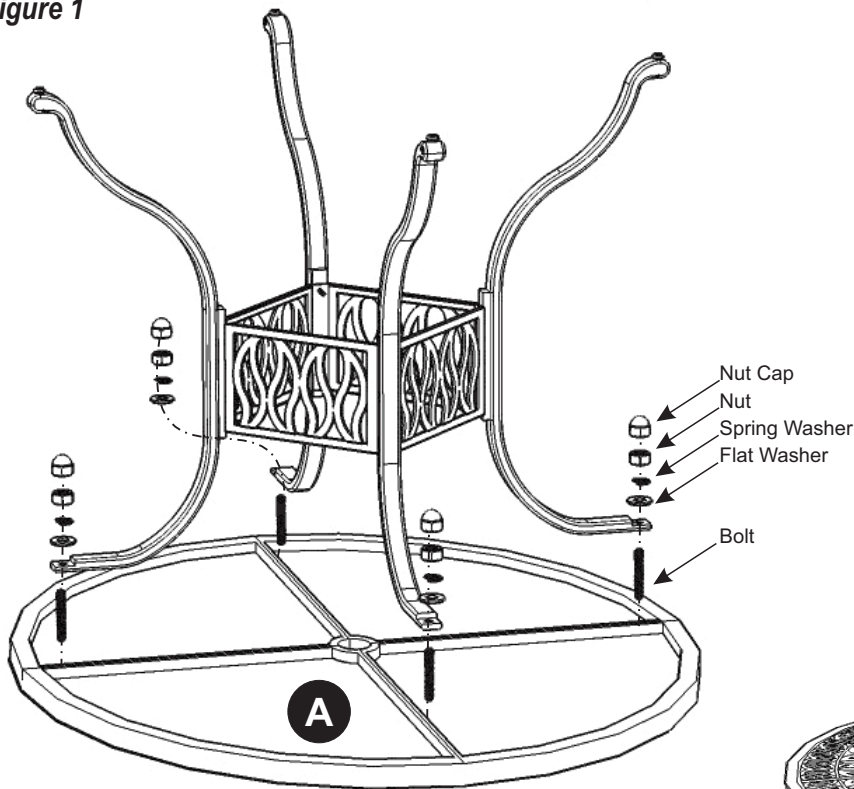

Figure 2

## STEP 2

Insert Bolts into the pre-drilled holes of Top (A) by using Slotted Screwdriver. (See Figure 2)

Attach unit of Top (A) with Flat Washers, Spring Washers, Nuts and Nut Caps.



## STEP 3

Turn the table to its' upright position.

Cover the umbrella hole with Cover.

To level the table, adjust the adjustable levelers on the bottom of legs. (See Figure 3)

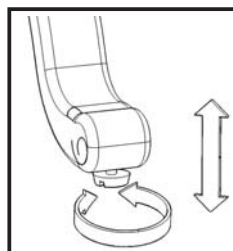

Figure 3

